

Revolt 2 Build Guide

Thank you for purchasing an iBUYPOWER Revolt 2 SFF Case

- This is a unique case designed and built exclusively for iBUYPOWER. Since this is the first time the case is being offered for DIY assembly, here is a guide to help build your system. Since the unique layout means some tricky wiring and routing.
- If you have any difficulties or questions regarding this case, please contact our support or hit us up on social media for assistance



Important Compatibility Notes

- ITX Motherboards only
- PSU Length
 - 170mm with 240 or 280mm cooling
 - 190mm with 120mm or 140mm cooling
- RAM Height
 - Under 44mm
- Pump height
 - Under 30mm with side exit tubing
- GPU Dimensions
 - 280 x 130 x 50 mm
 - **Blower Style cooler highly recommended for any 200w+ card**

Main Layout

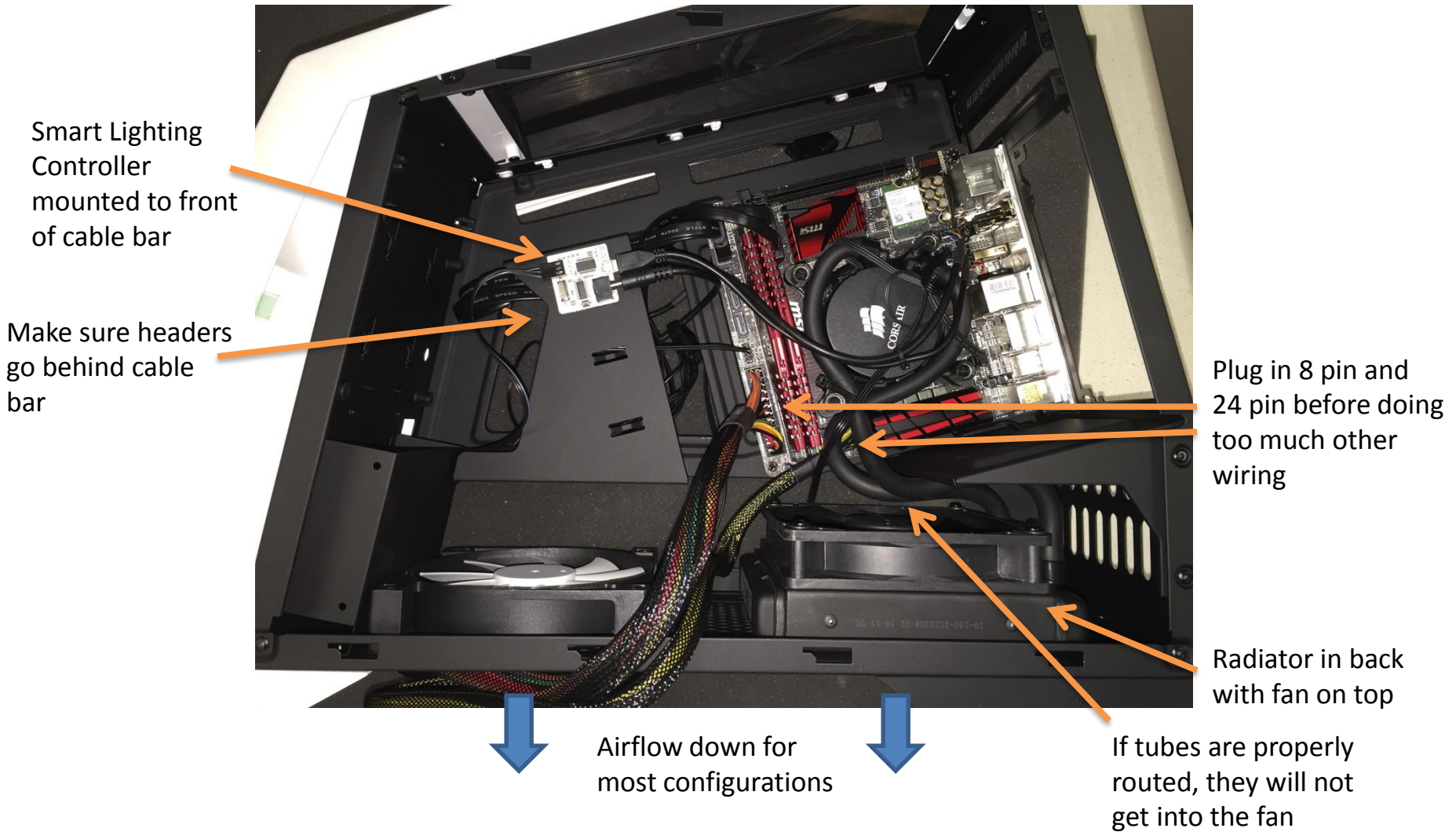

Smart Lighting Controller mounted to front of cable bar

Make sure headers go behind cable bar

Plug in 8 pin and 24 pin before doing too much other wiring

Radiator in back with fan on top



Airflow down for most configurations



If tubes are properly routed, they will not get into the fan

Tube Routing and Motherboard Headers

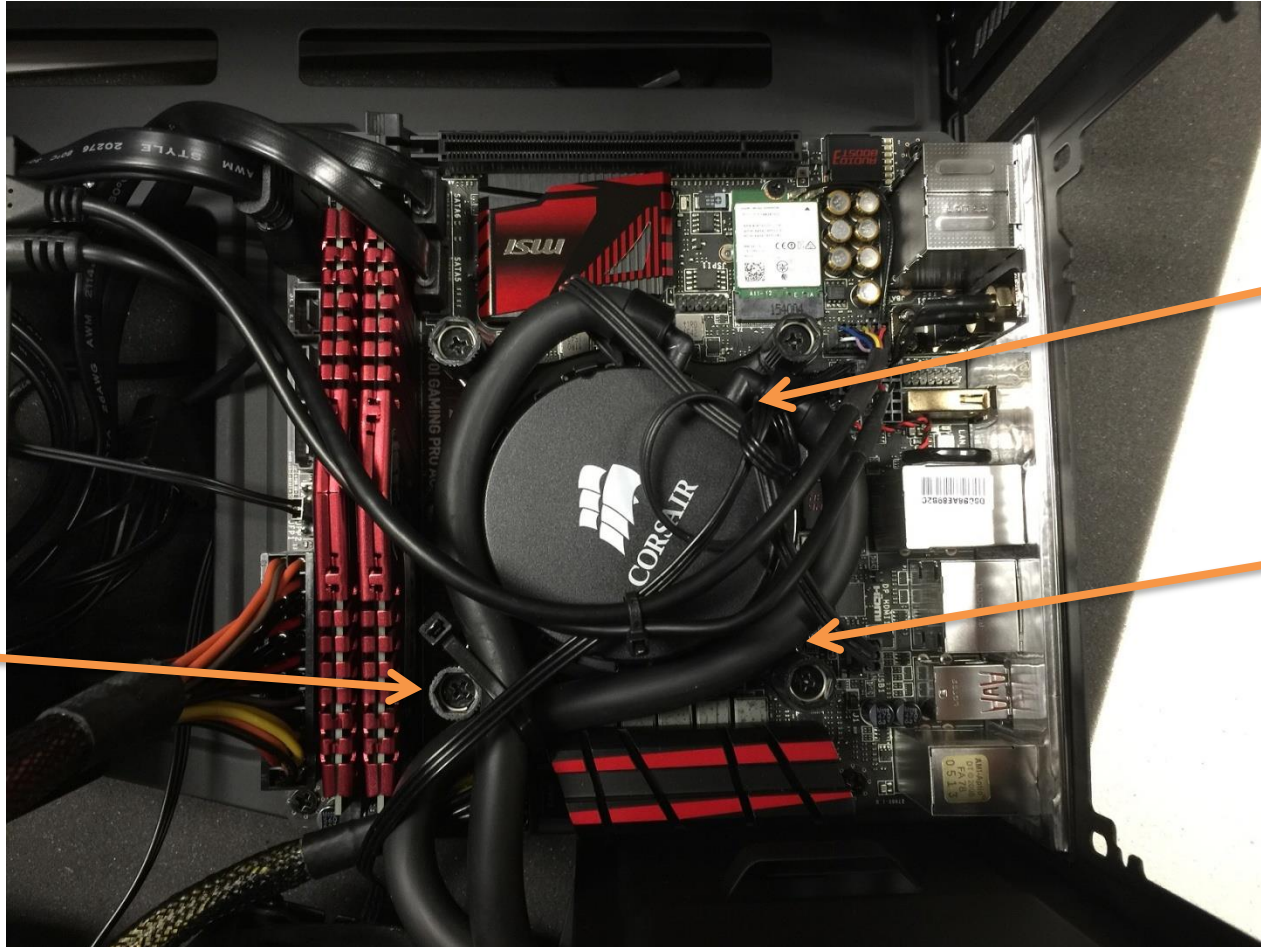

Pump should be mounted diagonally, not lined up with screws like normal

Tubes will route flat around the screws

Cross tubes this way and zip tie them to the pump bracket

Make sure to put the correct tube on top, it helps keep the 8 pin plug clear and makes the lengths right

Mounting PSU

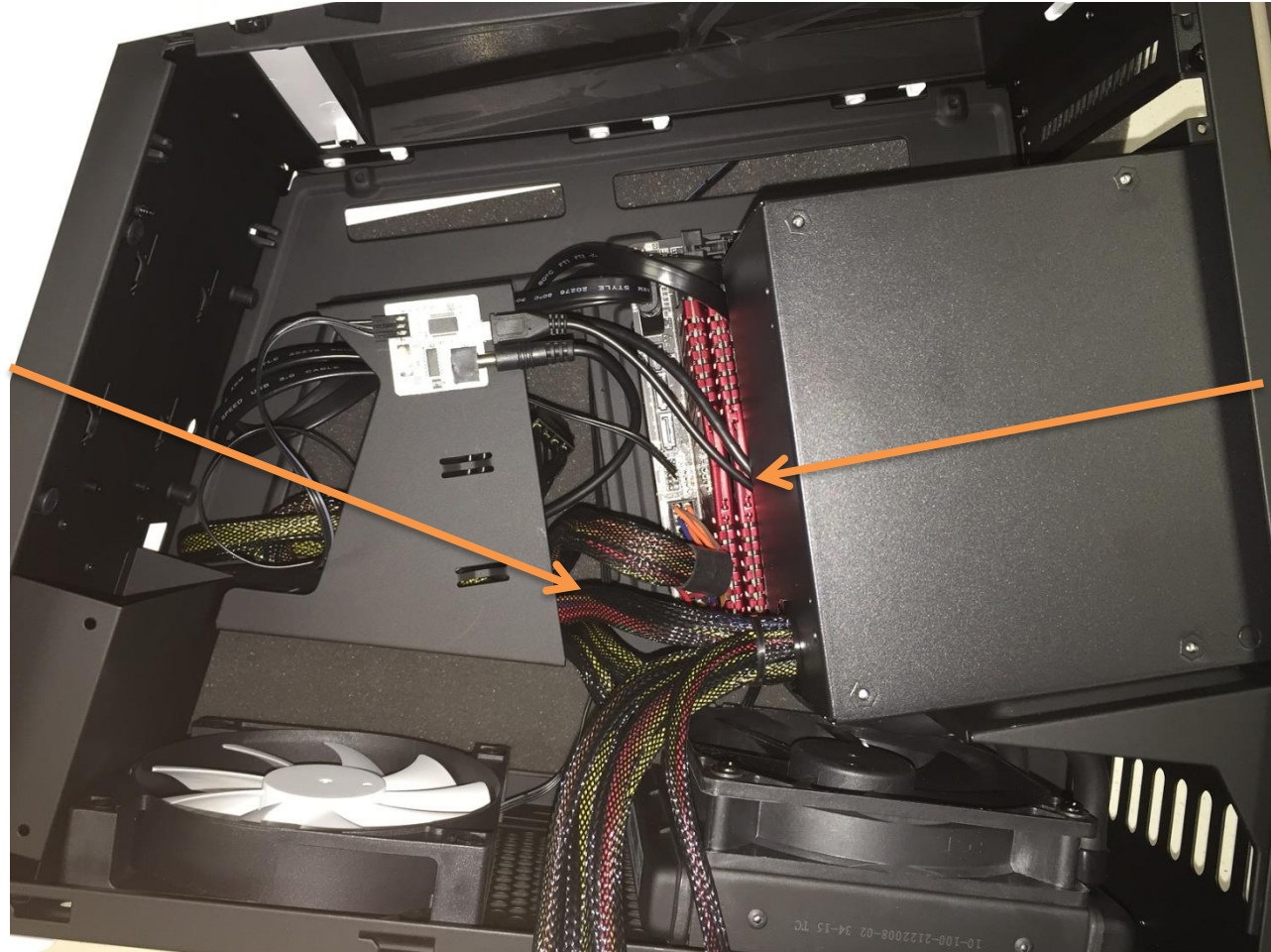

Pull the loops of the 24 pin and 8 pin through the cable management bar first. This is SUPER HELPFUL

Longer PSUs will cover up the whole board so make sure everything is plugged in first

Managing 24 and 8 pin

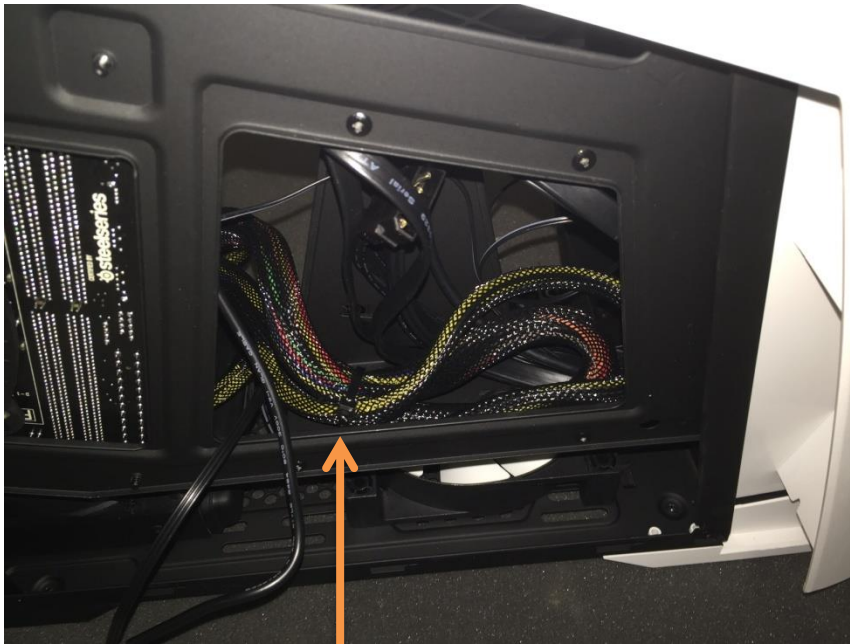

Zip tie the 24 and 8 pin down to the bottom of the cable bar. Don't catch any of the headers in this



Next start pulling the other cables through. Bundle unused cables.

Cable Management Continued



Tie header cables up high on the cable bar

Pull Video Card cables through the other side.

If there is a Mechanical Drive, pull one SATA power cable through here too

Video Card Power



Bind the Video Card power cables together. Usually helps to tie them in a loop to themselves so they hold onto the cable bar.

Try to keep the space above this fan as open as possible

Behind the Cable Bar

By tying the 24 pin down to the bottom in the first few steps, you should have plenty of space to tuck cables in here



You may need to add a zip tie or two to keep wires from falling out, but the side panel is very open so you don't need to smash them down too much

Mounting the SSD



When mounting the SSD to the tray, make sure to push the bottom edge towards the bracket when you tighten the screws



The plugs for the SSD are semi flexible so you might need to pull the outer plug towards the front of the case to get it to line up with the SSD

When using both SATA ports up front, it is highly recommended to not use the metal carrier, as it will become much more difficult to remove due to double the friction.

RGB Lighting



- The case has RGB lighting which is controlled by our Smart Lighting software, available on our driver page.
<https://www.ibuypower.com/Support/driver>
- The lighting is standard addressable lighting so mod-savvy folks can easily convert the plug to use standardized RGB headers and bypass the smart lighting controller. The pinout is shown here:

